

## BN01 Avibulb XT

Dome head · Steel body · Steel stem · High performance bulbing  
6.4 mm (1/4")

### Features

- High performance structural breakstem fastener with excellent bulbing tail formation
- High shear and tensile strength and high residual clamp load providing strong, vibration resistant joints
- Multi-grip capability accommodates wide variations in material thickness
- Spreads the tail bearing load/clamp load on the rear sheet making it ideal for use in thin sheet materials
- Suitable also in softer materials
- Retained stem avoids damage, electrical problems or rattling caused by loose stems
- Underhead recess accommodates burrs around holes and spreads the load evenly on the top sheet

### Material

- Body: Low carbon steel, zinc plated, clear trivalent passivated
- Stem: Medium carbon steel, zinc plated, clear trivalent passivated

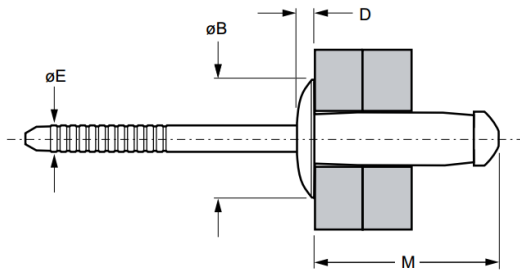

Before Placement

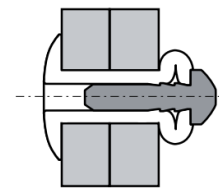

After Placement

Part No.	Size ø	Grip Range		Hole Size		M	øB	D	øE	Shear (typical) kN	Tension (typical) kN
		min.	max.	min.	max.						
0BN01-00816	6.4 (1/4")	1.5	5.5	6.6	7.0	17.3	13.4	3.1	4.87	11.1	6.8
0BN01-00820		5.0	9.0			21.3					



### Can't find what you are looking for?

We can provide customized finishing and colouring.  
Contact your nearest [Gripwell](#) team for assistance!